

ON-STREET PARKING (GRIGGS TO DUNLAP-NORTH)
 EXISTING: 12 SPACES
 PROPOSED: 0 SPACE

ON-STREET PARKING (DUNLAP TO LEXINGTON-NORTH)
 EXISTING: 13 SPACES
 PROPOSED: 0 SPACES

EXISTING CROSS STREET PARKING
 GRIGGS ST N (NORTH): 12 SPACES

EXISTING CROSS STREET PARKING
 DUNLAP ST N (NORTH): 11 SPACES

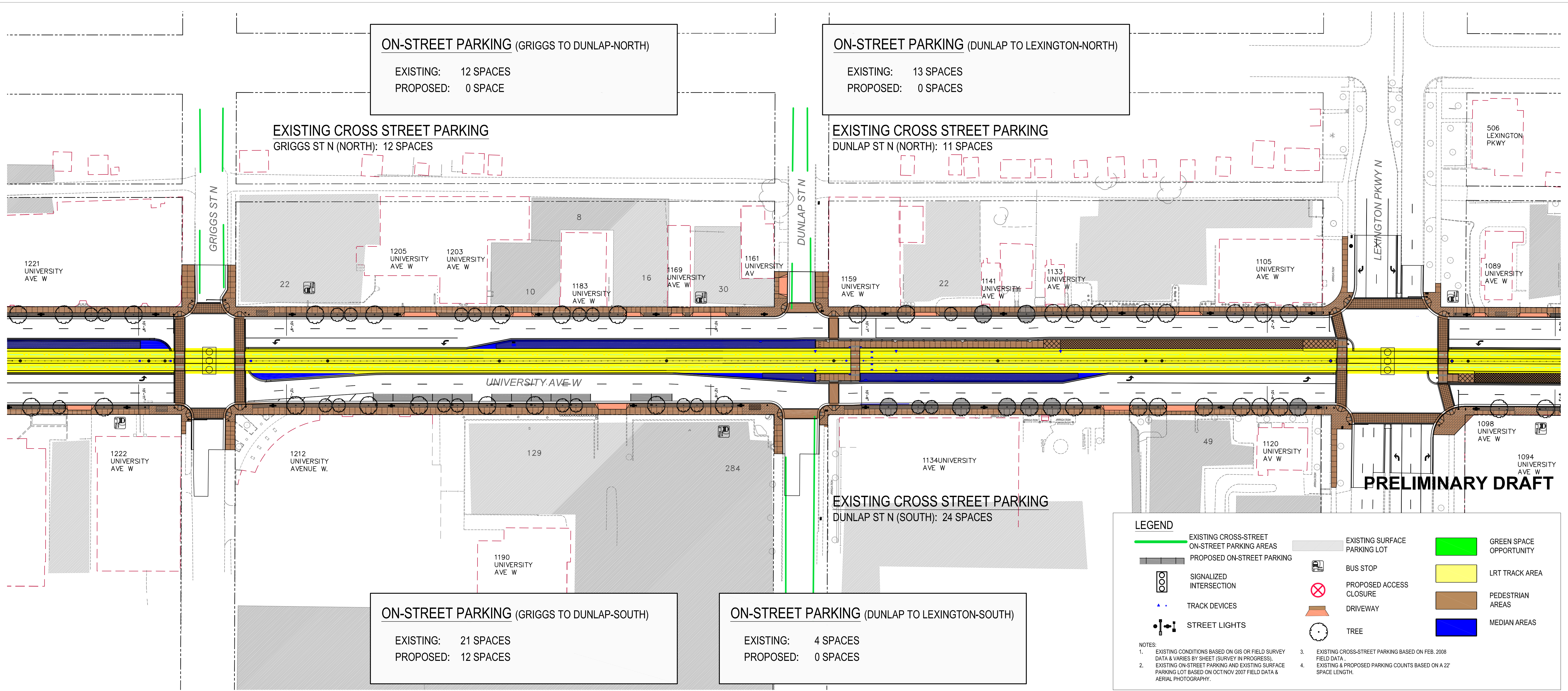

1221 UNIVERSITY AVE W

1222 UNIVERSITY AVE W

1205 UNIVERSITY AVE W

1212 UNIVERSITY AVENUE W.

1203 UNIVERSITY AVE W

1183 UNIVERSITY AVE W

129

1169 UNIVERSITY AVE W

284

1161 UNIVERSITY AV

1159 UNIVERSITY AVE W

1134 UNIVERSITY AVE W

1141 UNIVERSITY AVE W

49

1133 UNIVERSITY AVE W

1105 UNIVERSITY AVE W

1120 UNIVERSITY AV W

1089 UNIVERSITY AVE W

1098 UNIVERSITY AVE W

506 LEXINGTON PKWY

1094 UNIVERSITY AVE W

ON-STREET PARKING (GRIGGS TO DUNLAP-SOUTH)
 EXISTING: 21 SPACES
 PROPOSED: 12 SPACES

ON-STREET PARKING (DUNLAP TO LEXINGTON-SOUTH)
 EXISTING: 4 SPACES
 PROPOSED: 0 SPACES

PRELIMINARY DRAFT

LEGEND

	EXISTING CROSS-STREET ON-STREET PARKING AREAS		EXISTING SURFACE PARKING LOT		GREEN SPACE OPPORTUNITY
	PROPOSED ON-STREET PARKING		BUS STOP		LRT TRACK AREA
	SIGNALIZED INTERSECTION		PROPOSED ACCESS CLOSURE		PEDESTRIAN AREAS
	TRACK DEVICES		DRIVEWAY		MEDIAN AREAS
	STREET LIGHTS		TREE		

NOTES:

- EXISTING CONDITIONS BASED ON GIS OR FIELD SURVEY DATA & VARIES BY SHEET (SURVEY IN PROGRESS). EXISTING ON-STREET PARKING AND EXISTING SURFACE PARKING LOT BASED ON OCT/NOV 2007 FIELD DATA & AERIAL PHOTOGRAPHY.
- EXISTING CROSS-STREET PARKING BASED ON FEB. 2008 FIELD DATA. EXISTING & PROPOSED PARKING COUNTS BASED ON A 22' SPACE LENGTH.